

The new turret interface for high productivity mill/turning centres

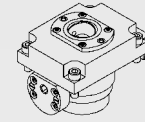

Clamping unit straight

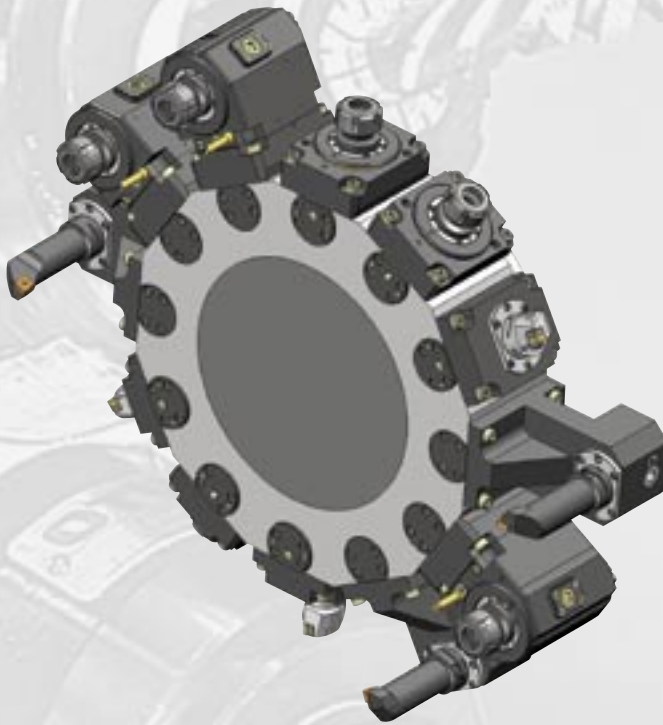
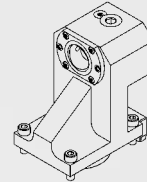

Clamping unit right angle

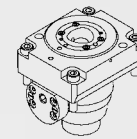

Drill/Milling unit straight

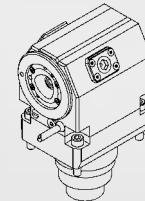

Drill/Milling unit right angle

CDI = Advanced Technology

- + High stability and rigidity
- + Same interface for static and driven toolholders
- + Flexible and symmetric interface (180° mountable)
- + Centerline adjustment for right angle toolholders
- + Shorter tool projection resulting in longer tool capabilities

CDI = More Customer Value

- + Higher cutting performance
- + Longer cutting tool life
- + Better workpiece quality
- + More available tool length for radial drilling operations

CDI / VDI - Higher Rigidity

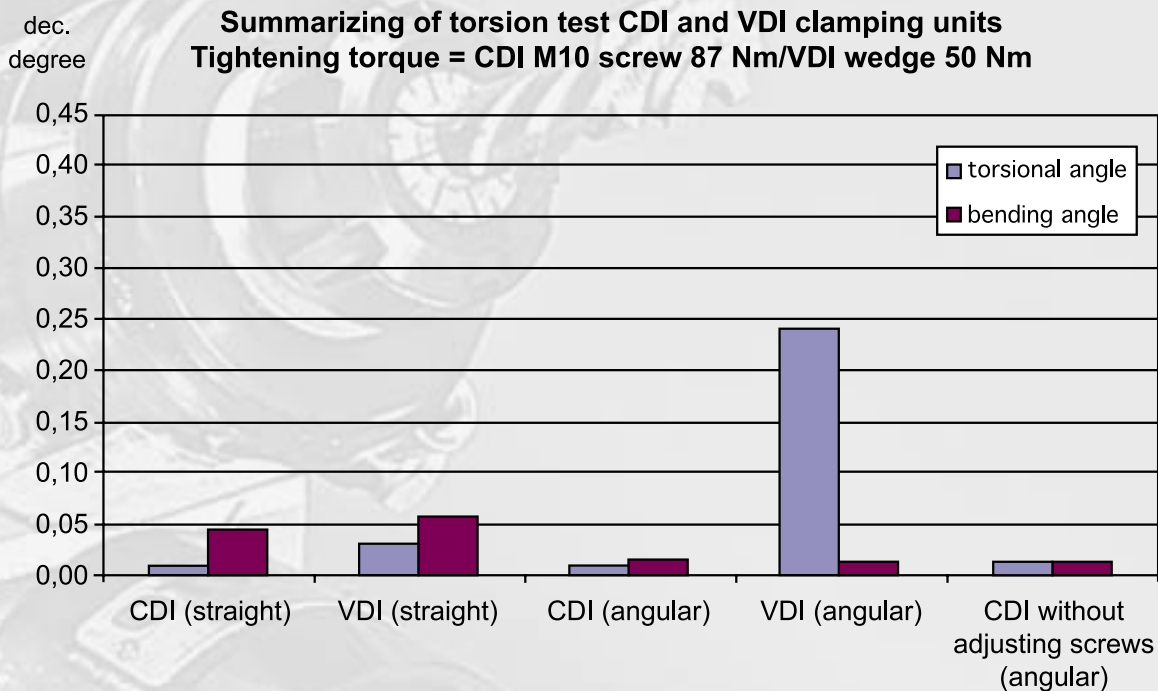

CDI: Standard sizes

- + CDI 58 → Coromant Capto™ 3
turret disk size / 260 mm
DTH with 32 Nm, 6000 1/min
internal coolant supply
- + CDI 68 → Coromant Capto™ 4
turret disk size / 320 mm
DTH with 63 Nm, 6000 1/min
internal coolant supply
- + CDI 80 → Coromant Capto™ 5, 6
turret disk size / 380 mm
DTH with 63/125 Nm, 6000 1/min
internal coolant supply

CDI: Available machine models

- + CDI 58 Index G160
Benzinger TNI, TCM*
- + CDI 68 Emag VSC 200, 250
Emco HT-665
Hessapp DVT-250, 300
Okuma Macturn 350, LT 300M
Takisawa TMM-250*
- + CDI 80 Emag VSC 400, 500
Emco HT-690
Gildemeister GMX 400, 500
Hessapp DVT-550
Index G400
Mori Seiki ZT-2500Y
Traub TNA 700
* currently in design stage