

Right angle drill/milling unit with Coromant Capto™ - Cycle controlled lathes -

Suitable for WTO turret block only.
For manual tool change; decentral drive.

Ratio = 1:1

Max. coolant pressure = 435 PSI (30 bar)
(Check specified coolant pressure diagram!)

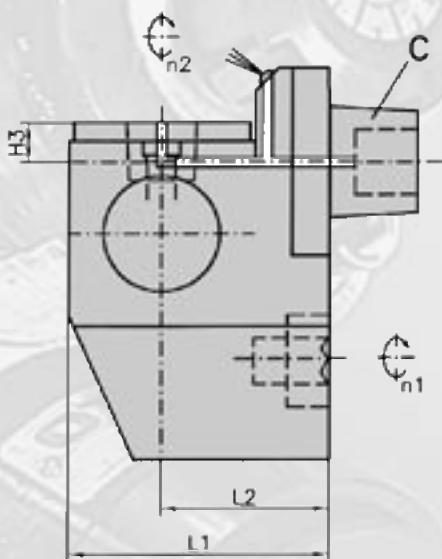

4105... (IC - HP) with internal + external coolant supply

Torque wrench must be used!

| Item No. | Turret block interface | | Clamping System | | | | Dimensions / Data | | | | | Coolant | Drw. No. |
|--------------|------------------------|--|-----------------|--|--|--|-------------------|-----|----|------|-------------|------------------|--------------------------|
| | C | | Size | | | | L1 | L2 | H3 | M Nm | Ratio n1:n2 | Pressure diagram | |
| 410504000-06 | C6 | | C4 | | | | 110 | 72 | 18 | 80 | 1:1 | D01002 | 343-830820... ...N123 |
| 410505000-06 | C6 | | C5 | | | | 120 | 72 | 30 | 100 | 1:1 | D01002 | ...N114 |
| 410505000-08 | C8 | | C5 | | | | 120 | 72 | 30 | 100 | 1:1 | D01002 | ...N485 |
| 410506000-08 | C8 | | C6 | | | | 195 | 125 | 70 | 100 | 1:1 | D01012 | ...N778 |